

# KURO – Information for invitation to tender

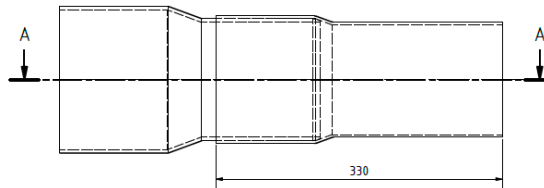

**Product:**

**PVC reducing socket**



## Information for invitation to tender:

- |           |   |
|-----------|---|
| Pos:..... | PVC Reducing socket in accordance with DIN 16873<br>Colour: grey reduced: 63 / 50 mm<br>System KURO o. glw. ( <a href="http://www.kuro-kunststoffe.de">www.kuro-kunststoffe.de</a> ),<br>supply and install, as an addition to pos: .....<br><br>Amount:.....Pieces    UP: .....    TP: ..... |
| Pos:..... | PVC Reducing socket in accordance with DIN 16873<br>Colour: grey reduced: 75 / 50 mm<br>System KURO o. glw. ( <a href="http://www.kuro-kunststoffe.de">www.kuro-kunststoffe.de</a> ),<br>supply and install, as an addition to pos: .....<br><br>Amount:.....Pieces    UP: .....    TP: ..... |
| Pos:..... | PVC Reducing socket in accordance with DIN 16873<br>Colour: grey reduced: 75 / 63 mm<br>System KURO o. glw. ( <a href="http://www.kuro-kunststoffe.de">www.kuro-kunststoffe.de</a> ),<br>supply and install, as an addition to pos: .....<br><br>Amount:.....Pieces    UP: .....    TP: ..... |
| Pos:..... | PVC Reducing socket in accordance with DIN 16873<br>Colour: grey reduced: 90 / 75 mm<br>System KURO o. glw. ( <a href="http://www.kuro-kunststoffe.de">www.kuro-kunststoffe.de</a> ),<br>supply and install, as an addition to pos: .....<br><br>Amount:.....Pieces    UP: .....    TP: ..... |
| Pos:..... | PVC Reducing socket in accordance with DIN 16873<br>Colour: grey reduced: 90 / 85 mm<br>System KURO o. glw. ( <a href="http://www.kuro-kunststoffe.de">www.kuro-kunststoffe.de</a> ),<br>supply and install, as an addition to pos: .....<br><br>Amount:.....Pieces    UP: .....    TP: ..... |

Pos:.....  
 PVC Reducing socket in accordance with DIN 16  
 Colour: grey reduced: 110 / 63 mm  
 System KURO o. glw. ([www.kuro-kunststoffe.de](http://www.kuro-kunststoffe.de)),  
 supply and install, as an addition to pos: .....

Amount:.....Pieces UP: ..... TP: .....

Pos:.....  
 PVC Reducing socket in accordance with DIN 16873  
 Colour: grey reduced: 110 / 75 mm  
 System KURO o. glw. ([www.kuro-kunststoffe.de](http://www.kuro-kunststoffe.de)),  
 supply and install, as an addition to pos: .....

Amount:.....Pieces UP: ..... TP: .....

Pos:.....  
 PVC Reducing socket in accordance with DIN 16873  
 Colour: grey reduced: 110 / 85 mm  
 System KURO o. glw. ([www.kuro-kunststoffe.de](http://www.kuro-kunststoffe.de)),  
 supply and install, as an addition to pos: .....

Amount:.....Pieces UP: ..... TP: .....

Pos:.....  
 PVC Reducing socket in accordance with DIN 16873  
 Colour: grey reduced: 110 / 90 mm  
 System KURO o. glw. ([www.kuro-kunststoffe.de](http://www.kuro-kunststoffe.de)),  
 supply and install, as an addition to pos: .....

Pos:.....  
 Amount:.....Pieces UP: ..... TP: .....  
 PVC Reducing socket in accordance with DIN 16873  
 Colour: grey reduced: 110 / 106 mm  
 System KURO o. glw. ([www.kuro-kunststoffe.de](http://www.kuro-kunststoffe.de)),  
 supply and install, as an addition to pos: .....

Amount:.....Pieces UP: ..... TP: .....

Pos:.....  
 PVC Reducing socket in accordance with DIN 16873  
 Colour: grey reduced: 110 / 125 mm  
 System KURO o. glw. ([www.kuro-kunststoffe.de](http://www.kuro-kunststoffe.de)),  
 supply and install, as an addition to pos: .....

Amount:.....Pieces UP: ..... TP: .....

Pos:.....  
 PVC Reducing socket in accordance with DIN 16873  
 Colour: grey reduced: 125 / 110 mm  
 System KURO o. glw. ([www.kuro-kunststoffe.de](http://www.kuro-kunststoffe.de)),  
 supply and install, as an addition to pos: .....

Amount:.....Pieces UP: ..... TP: .....

Pos:.....  
PVC Reducing socket in accordance with DIN 16873  
Colour: grey reduced: 140 / 125 mm  
System KURO o. glw. ([www.kuro-kunststoffe.de](http://www.kuro-kunststoffe.de)),  
supply and install, as an addition to pos: .....

Amount:.....Pieces    UP: .....    TP: .....

Pos:.....  
PVC Reducing socket in accordance with DIN 16873  
Colour: grey reduced: 160 / 110 mm  
System KURO o. glw. ([www.kuro-kunststoffe.de](http://www.kuro-kunststoffe.de)),  
supply and install, as an addition to pos: .....

Amount:.....Pieces    UP: .....    TP: .....

Pos:.....  
PVC Reducing socket in accordance with DIN 16873  
Colour: grey reduced: 160 / 140 mm  
System KURO o. glw. ([www.kuro-kunststoffe.de](http://www.kuro-kunststoffe.de)),  
supply and install, as an addition to pos: .....

Amount:.....Pieces    UP: .....    TP: .....

Pos:.....  
PVC Reducing socket in accordance with DIN 16873  
Colour: grey reduced:  
System KURO o. glw. ([www.kuro-kunststoffe.de](http://www.kuro-kunststoffe.de)),  
supply and install, as an addition to pos: .....

Amount:.....Pieces    UP: .....    TP: .....